

PTH Formaldehyde (HCHO) Gas Monitor User Manual

Please read this manual carefully and take good care of it before using the product.

Thank you for purchasing PTH series formaldehyde monitor. The use of a new generation of British Dart imported formaldehyde sensor, can effectively detect the weak formaldehyde gas in the air, avoid the human body from formaldehyde and other harmful substances. It is suitable for formaldehyde and harmful gas monitoring in cars, nurseries, homes, offices and other occasions.

Features

- 1) Adopt the British Dart new generation anti-interference formaldehyde sensor, the measurement is more accurate;
- 2) Support TVOC harmful gas monitoring (only PTH-2 / PTH-3M);
- 3) Temperature and humidity measurement;
- 4) Indicator lights, simulation bars and facial expressions indicate multiple air quality levels;
- 5) Support recording function (only PTH-3M);
- 6) Support Bluetooth and Mijia APP (only PTH-3M);
- 7) Screen backlight 10 minutes automatically turn off function, one button to wake up;
- 8) Large capacity 18650 lithium battery with long battery life;
- 9) Support USB charging mode;
- 10) Support a variety of fixing methods, such as vehicle (optional vehicle bracket), table placement or rope suspension.

Packing List

Please check the list of accessories for the instruments you purchased according to different models.

- | | | |
|-----------------|---------------------------------|---------------------------------|
| 1. PTH × 1 | 2. 18650 Battery × 1 (Built-in) | 3. Stand for car × 1 (optional) |
| 4. USB Line × 1 | 5. Manual × 1 | 6. Hanging line × 1 |

Special statement: the products, accessories and user interface illustrations in the manual are all schematic diagrams for reference only. If there is a difference between the physical object of the product and the schematic diagram due to the update and upgrade of the product, the physical object received shall prevail and the manufacturer will not give prior notice.

Operation

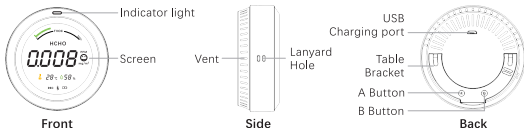

1. Product illustration



2. Charging

When charging with the Micro USB that comes with the instrument, please use a power adapter with a specification of "5V = 1A". When using a third-party USB cable, please be careful not to exceed 1m in length to prevent excessive voltage drop from being unable to recharge. please use qualified chargers and chargers, not non-standard power adapters.

In general, the battery is fully charged and takes about 3 to 4 hours. Please do not use both charging interfaces at the same time. The following is a comparison table of the changes in the battery charge icon displayed on the screen and the charging status.

LCD	Status
 Icon displays	Full
 Icon flicker	Charging
 Icon flicker	Low power

3. Measuring

Press the A key, the instrument starts to work, the screen will display formaldehyde, temperature and humidity values, if it is PTH-2 or PTH-3 M, it will also display the simulation bar of TVOC.

In order to ensure the accuracy of the measurement data, please do not touch the instrument with your hands during the measurement process. Please rest for at least 10 minutes to obtain a stable measurement value.

4. Buttons

Button	Operation	PTH-1	PTH-2	PTH-3M
A	Short	On / Backlight	On / Backlight	On / Backlight
	Long	Off	Off	Off
B	Short	°C/°F / backlight	°C/°F / backlight	°C/°F / backlight
	Long	Backlight	Backlight	On/off bluetooth
A+B	Press together	/	/	Delete record

Description:

- 1) In the state of the information screen, the user can wake up the backlight by pressing any key. After each awakening, if there is no keystroke operation, the product will automatically turn off the backlight of the screen after 10 minutes, but the indicator light still indicates the current air quality.
- 2) For PTH-1 and PTH-2, if you need to switch the backlight mode, you can press the B key for a long time. By default, the 10 minute no-operation button turns off the backlight mode. At this time, the indicator light is the breath gradient effect, and the backlight constant mode is the constant light mode.
- 3) For PTH-3M, if you need to change the backlight mode, you can set the backlight mode through Mijia APP: optional "always bright mode", "automatic message screen mode".

5. Data Record (only PTH-3M)

The formaldehyde monitor model PTH-3M supports data recording function. It can connect Mijia APP through Bluetooth and set recording parameters. Up to 8000 pieces of data can be recorded.



Please set the record interval through Mijia APP. The record interval defaults to 5 minutes.

Note: the recording function can only be started by pressing the B key after setting the recording parameters by Mijia APP. In order to ensure the integrity of the data, please use an external power adapter to supply power during the recording process.

For detailed instructions on data recording, please read the relevant chapters of Mijia APP.

6. Alert

Whether the formaldehyde value exceeds the standard is indicated by the expression icon and indicator light, as shown in the following table:

		
Bad	Normal	Good

When the measured value is between 0 and 0.08 mg/m³, the formaldehyde value belongs to the safe range;
 When the measured value is at 0.08 ~ 0.1 mg/m³, the formaldehyde value belongs to the warning range and needs close observation;

When the measured value exceeds 0.1 mg/m³, the formaldehyde value exceeds the standard and must be treated with formaldehyde.

You can also directly judge whether the formaldehyde value exceeds the standard through the indicator light. The following is the comparison table of indicator light color and its meaning:

Light	Meaning
Green	Good
Yellow	Normal
Red	Bad

PTH-2 & PTH-3M have TVOC indicator as below:

Indicator	TVOC
Green	not exceed
Yellow	Going to exceed
Red	Exceed

Note: That the warm-up time of the TVOC sensor is 5 minutes.

7. Mijia app operation instructions (this function is limited to PTH-3M only)

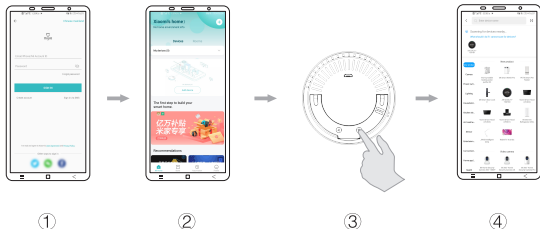

Open the Mijia app,
Register and log in

After entering the app UI,
turn on Bluetooth and location.
Click on the bottom Icon"".
When you switch to this tab,
Click on "Add device",
or the icon in the upper right
corner"

Long press the B key
on the back, turn on
the Bluetooth function

Scan and select nearby
devices products in list

Attention

1. In Figure 1, different countries and regions have different ways to log in
2. When searching for devices, the app may require the mobile phone to authorize Bluetooth functions, location positioning and other functions, and the whole process needs to be networked;
3. If there are too many products displayed or no products found in the scan list, you can enter "AIR QUALITY TESTER" in the search box above and search;
4. When the Bluetooth function of the product is turned on but the device is not connected, the Bluetooth icon on the screen will always flash; after the connection is successful, the Bluetooth icon will always display.

Specifications

The following table provides the specifications of the measurement parameters

Spec	PTH-1	PTH-2	PTH-3M
Formaldehyde	0.001mg/m ³	0.001mg/m ³	0.001mg/m ³
Temperature	-10~40°C(±1°C)	-10~40°C(±1°C)	-10~40°C(±1°C)
Humidity	20~80%(±5%RH)	20~80%(±5%RH)	20~80%(±5%RH)
TVOC	×	√	√
Data Record	×	×	√
Bluetooth	×	×	√
Power Supply	18650 battery / 2400mAh	18650 battery / 2400mAh	18650 battery / 2400mAh
Indicator	√	√	√
MiJia APP	×	×	√
CMIIT ID	/		2019DP10532
Input	DC 5V=1A		
Size	83×83×32mm		
Working Temp	0°C~40°C		
Standard	Q/FBS J0201-2019		

Attention

- 1) This product should not be dipped in water, nor should it be placed in a high temperature environment exceeding 60 °C.
- 2) This product belongs to precision measuring instrument and shall not be dismantled without authorization.
- 3) It can not be measured in the environment of organic gas with too high concentration for a long time.
- 4) Before use, please turn on the instrument in fresh air for a few minutes so that the sensor can return to zero.
- 5) The formaldehyde sensor is an electrochemical principle and has a certain lag effect. Please do not less than 10 minutes when measuring.
- 6) When formaldehyde or TVOC alarm, please timely ventilation;
- 7) Built-in lithium battery, when measuring the air quality in the car, please do not put the formaldehyde monitor with lithium battery in the sun;
- 8) When charging, due to the heating of the charging circuit and the battery, the temperature and humidity value may be 3 ~ 5 °C higher than the normal value. To obtain an accurate temperature and humidity measurement value, please read it after the charging is completed.